



(11) **EP 1 773 621 B1**

(12) **EUROPEAN PATENT SPECIFICATION**

(45) Date of publication and mention  
of the grant of the patent:  
**02.09.2009 Bulletin 2009/36**

(51) Int Cl.:  
**B60P 3/40 (2006.01) F03D 1/00 (2006.01)**

(21) Application number: **05753544.5**

(86) International application number:  
**PCT/DK2005/000437**

(22) Date of filing: **28.06.2005**

(87) International publication number:  
**WO 2006/000230 (05.01.2006 Gazette 2006/01)**

(54) **A METHOD FOR THE TRANSPORT OF A LONG WINDMILL WING AND A VEHICLE FOR THE TRANSPORT THEREOF**

VERFAHREN FÜR DEN TRANSPORT EINES LANGEN WINDMÜHLENFLÜGELS UND FAHRZEUG FÜR SEINEN TRANSPORT

PROCEDE ET VEHICULE PERMETTANT LE TRANSPORT D'UNE LONGUE PALE D'EOLIENNE

(84) Designated Contracting States:  
**AT BE BG CH CY CZ DE DK EE ES FI FR GB GR  
HU IE IS IT LI LT LU MC NL PL PT RO SE SI SK TR**  
Designated Extension States:  
**AL BA HR LV MK YU**

(72) Inventor: **JENSEN, Jørgen, Egeskov**  
**DK-6580 Vamdrup (DK)**

(30) Priority: **29.06.2004 DK 200401026**

(74) Representative: **Larsen, Hans Ole et al**  
**Larsen & Birkeholm A/S**  
**Skandinavisk Patentbureau**  
**Banegaardspladsen 1**  
**P.O. Box 362**  
**1570 Copenhagen V (DK)**

(43) Date of publication of application:  
**18.04.2007 Bulletin 2007/16**

(60) Divisional application:  
**09009143.0**

(56) References cited:  
**WO-A-03/057528 WO-A-20/04041589**  
**JP-A- 2002 059 776 US-A- 4 750 785**

(73) Proprietor: **Vamdrup Specialtransport APS**  
**6580 Vamdrup (DK)**

**EP 1 773 621 B1**

Note: Within nine months of the publication of the mention of the grant of the European patent in the European Patent Bulletin, any person may give notice to the European Patent Office of opposition to that patent, in accordance with the Implementing Regulations. Notice of opposition shall not be deemed to have been filed until the opposition fee has been paid. (Art. 99(1) European Patent Convention).

## Description

**[0001]** The invention relates to a method for the transport of a long windmill wing, wherein the windmill wing is transported on a vehicle, and wherein the windmill wing is secured at its one end to a tractive vehicle and is secured at its opposite end to a non-tractive vehicle.

**[0002]** The invention moreover relates to a vehicle for the transport of a long windmill wing, said vehicle being composed of a tractive vehicle to which one end of the windmill wing is secured, and a non-tractive vehicle to which the other end of the windmill wing is secured.

**[0003]** In the production of energy in the form of electricity, ever greater demands are made by politicians and citizens in general with respect to replacing the fossil fuels with alternative renewable sources of energy, such as biogas systems, wave systems and windmill energy.

**[0004]** Windmill energy in particular has obtained an ever more prominent position in recent years, as it has been developed such that not inconsiderable amounts of energy can be produced by ever more effective windmills.

**[0005]** The greater efficiency of the windmills has been achieved technologically on the basis of the development of new materials having mechanical properties which make it possible today to manufacture windmill wings with a length of up to more than 60 metres and with a weight of about 18 tons.

**[0006]** Within a few years it will presumably be possible to manufacture windmill wings which have a length of between 80 and 100 metres.

**[0007]** When so large windmill wings are to be transported from the factory to the installation site, long special vehicles have been used till now where the windmill wing has rested on a long metal connection profile which is connected between the tractive part of a vehicle and a wheeled platform at the opposite end of the vehicle.

**[0008]** Such a vehicle may typically have a weight of the order of 35 - 40 tons. When the weight of the windmill wing is added, the total weight is of the order of 53 - 58 tons, which gives a considerable axle load on the vehicle which transports the windmill wing.

**[0009]** As the distance of the connection profile to the surface of the ground is very small, it may of course be difficult to manoeuvre the vehicle round corners if road signs or differences in level, e.g., are present at the corners.

**[0010]** WO 03/057528 A1 disclose a vehicle for the transport of a windmill wing, where the windmill wing is suspended between a tractive and a non-tractive vehicle.

**[0011]** As will be known, a windmill wing is configured as a partially flat structure which may have a thickness of 3.5 - 4.5 metres at its thick place at the root of the windmill wing, and a width which may be 4.5 - 5.5 metres at its widest place.

**[0012]** The suspension according to the WO publication is configured such that the windmill wing may be rotated about its longitudinal axis so that it may assume

a "high" as well as a "wide" position, which means that if the windmill wing is to be moved through a viaduct having a height which is smaller than the width of the windmill wing, the windmill wing may be rotated about its longitudinal axis and thus be placed with its faces in a position such that the normal of the faces is perpendicular to the road. The windmill wing will hereby assume a position where the distance to the road surface is greatest.

**[0013]** Thus, in the known structure, it is the dimensions of the windmill which decide how high or how low the lowermost part of the windmill wing may be placed above a road, as the highest level means that the windmill wing must assume the widest position on the road, while the lowest level is achieved when the windmill wing stands up.

**[0014]** Accordingly, an object of the invention is to provide a method wherein the distance between the lowest part of the windmill wing and the surface of the road may be adjusted independently of the orientation of the windmill wing, and in a range which is greater than is possible in the known structure, and such that the distance between the lowest part of the windmill wing and the road surface may be adjusted without changing the position of the windmill wing on the vehicle.

**[0015]** A similar method is described WO 2004/041 589 A1.

**[0016]** The object of the invention is achieved by a method of the type defined in the introductory portion of claim 1 wherein the windmill wing is secured to the tractive vehicle by mounting a holding frame at one end of the windmill wing, said holding frame being coupled to a hydraulic system, which hydraulic system is arranged on the tractive vehicle, said hydraulic system being adapted to raise and lower the holding frame with the windmill wing, and the method is characterized in that the hydraulic system further comprises coupling means in the form of posts and in that the holding frame is coupled to the hydraulic system by inserting posts into holding parts on the holding frame.

**[0017]** The distance between the lowest parts of the windmill wing and the road surface may be adjusted in this manner, without this having as a result that space is occupied transversely to the road surface, and in a greater range than that conditioned by the dimensions of the windmill wing.

**[0018]** Thus, the distance may be adjusted in such a manner that the lower side of the windmill wing is very close to the road surface near the tractive vehicle, or may be adjusted very high if the windmill wing, e.g. in a bend, is to pass a road sign or other obstacle.

**[0019]** As mentioned, the invention also relates to a vehicle.

**[0020]** This vehicle is characterized in that the tractive vehicle is provided with a hydraulic system, which is arranged on a bracket provided on the tractive vehicle, and that the hydraulic system is adapted to raise or lower the windmill wing, and in that the hydraulic system further comprises coupling means in the form of posts for cou-

pling to a holding frame which is mounted on the one end of the windmill wing.

**[0021]** Hereby, it is possible during transport to adjust the height of the distance of the windmill wing from the road surface in a great range, and without it being necessary to rotate the windmill wing about its longitudinal axis, which can generally be a risky operation because of the inevitable forces that are generated during such a rotating movement.

**[0022]** For easy coupling of the tractive vehicle to the windmill wing it is an advantage if the hydraulic system comprises coupling means in the form of posts for coupling to a holding frame which is mounted at one end of the windmill wing. The manufactured windmill wings may hereby rapidly be made ready for transport merely by mounting the holding frame on one end of the windmill wing.

**[0023]** To improve the manoeuvrability of the vehicle additionally, it is an advantage if, as stated in claim 3, the hydraulic system is arranged rotatably about an axis perpendicular to the road on which the vehicle is manoeuvred, thereby retaining the stability of the ball turntable.

**[0024]** Further, it is advantageous if, as stated in claim 4, the non-tractive vehicle is constructed as a platform on which a carrier arrangement is rotatably arranged, and, as stated in claim 5, that the carrier arrangement is adjustable in the height, as control of the height of the rearmost part of the windmill wing around corners with possible obstacles, such as road signs, may be effected.

**[0025]** For good mechanical retention of the rearmost part of the windmill wing, it is an advantage if, as stated in claim 6, the carrier arrangement is constructed as a support which comprises holding profiles in the form of frames for holding the opposite end of the windmill wing and thus fixes the windmill wing.

**[0026]** In order to be able to steer the overall vehicle, it is additionally advantageous if, as stated in claim 7, the non-tractive vehicle is connected hydraulically and electrically to the tractive vehicle.

**[0027]** The invention will now be explained more fully with reference to the drawing, in which

fig. 1 shows the vehicle with mounted windmill wing,

fig. 2 shows the vehicle of fig. 1 during turning,

fig. 3 shows the tractive vehicle where the windmill wing has just been mounted,

fig. 4 shows the tractive vehicle of fig. 3, but with raised windmill wing made ready for transport,

fig. 5 shows the root end of a windmill wing with mounted holding frame, while

fig. 6 shows the non-tractive vehicle with mounted windmill wing fixed in holding profiles.

**[0028]** In figs. 1 and 2, the numeral 1 generally designates a vehicle according to the invention. The vehicle consists of a tractive vehicle 3 and a non-tractive vehicle 5. A windmill wing 2 is suspended between the tractive vehicle 3 and the non-tractive vehicle 5, as will be explained below. As will be seen, the tractive vehicle 3 and the non-tractive vehicle 5 are connected with each other only via the windmill wing 2 and hydraulic/electrical connections, which are shown at 6.

**[0029]** In fig. 1, the vehicle is shown on a straight stretch of road, while in fig. 2 it is shown during turning, and, as will be seen, the windmill wing 2 passes over a sign 7.

**[0030]** With reference now to fig. 3 and fig. 4, it will be explained how the windmill wing is secured to the tractive vehicle.

**[0031]** The tractive vehicle rotatably mounts a hydraulic system which is formed by a cylinder housing 4 in which a piston on a piston rod 11 may be moved in and out. The piston rod is secured to a pivot 10 on a bracket 21 which is fixed between two posts 12, while the cylinder housing 4 is secured to a pivot 14 on a bracket 18 which is in turn connected with a carrier member 15.

**[0032]** Via a bracket 19, the carrier member 15 is secured at its one end rotatably about a pivot 8 on a bracket 20, resting on a ball turntable on the tractive vehicle. The opposite end of the carrier member 15 is connected with a pivot 9 on a holding part 22 which is arranged in extension of the posts 12.

**[0033]** At the bottom, the two posts 12 are inserted into the holding parts 23, 24 on a holding frame 13 which is secured to the windmill wing 2.

**[0034]** The hydraulic system operates in the following manner:

When pressure is supplied to the cylinder housing 4 from the position shown in fig. 3, the holding frame 13 with the windmill wing 2 will be pulled upwards to the position shown in fig. 4, as the carrier member prevents the frame from being moved rearwards during the travel of the piston rod out of the cylinder housing 4. As will be seen, the angle between the carrier frame 15 and the cylinder housing 4 has become more acute.

**[0035]** When the windmill wing 2 on the frame 13 is to be lowered, the process is repeated in the reverse order.

**[0036]** Fig. 5 shows the windmill wing 2 with mounted frame 13 and the holding parts 23, 24 for receiving the posts 12 on the hydraulic system. As will be appreciated, it is relatively easy to make a windmill wing ready for transport, since just the bracket 13 is to be mounted on the windmill wing.

**[0037]** With reference now to fig. 6, it will be explained how the non-tractive vehicle 5 is constructed. A carrier arrangement 26 is secured on a rotatable part 25 on a platform 28, said carrier arrangement 26 being in the form of a support composed of a plurality of profiles which are

terminated at the top by fixing frames 27, which may be fixed around the rear end of the windmill wing, in that upper transverse rods 29 may be moved in a vertical direction and be fixed in vertical rods 30.

### Claims

1. A method for the transport of a long windmill wing (2), wherein the windmill wing is secured at its one end to a tractive vehicle (3) and is secured at its opposite end to a non-tractive vehicle (5), and wherein the windmill wing (2) is secured to the tractive vehicle (3) by mounting a holding frame (13) at one end of the windmill wing, said holding frame being coupled to a hydraulic system (4, 11), which hydraulic system is arranged on the tractive vehicle (3), said hydraulic system (4, 11) being adapted to raise and lower the holding frame with the windmill wing (2), **characterized in that** the hydraulic system further comprises coupling means in the form of posts and **in that** the holding frame (13) is coupled to the hydraulic system by inserting posts (12) into holding parts (23,24) on the holding frame (13).
2. A vehicle for the transport of a long windmill wing (2), said vehicle being formed by a tractive vehicle (3) to which one end of the windmill wing is secured, and a non-tractive vehicle (5) to which the other end of the windmill wing is secured, said tractive vehicle (3) being provided with a hydraulic system (4, 11) which is arranged on a bracket (21) provided on the tractive vehicle (3) and is adapted to raise or lower the windmill wing, **characterized in that** the hydraulic system (4,11) further comprises coupling means in the form of posts (12) for coupling to a holding frame (13) which is mounted on the one end of the windmill wing.
3. A vehicle according to claim 2, **characterized in that** the hydraulic system (4, 11) is mounted rotatably on an axis perpendicular to the road on which the vehicle is manoeuvred, and disposed on a ball turntable.
4. A vehicle according to claims 2 - 3, **characterized in that** the non-tractive vehicle (5) is provided with a platform on which a carrier arrangement (26) for fixing the windmill wing is rotatably arranged.
5. A vehicle according to claim 4, **characterized in that** the carrier arrangement (26) is adjustable in the height.
6. A vehicle according to claims 4 - 5, **characterized in that** the carrier arrangement (26) is constructed as a support comprising holding profiles in the form of frames (27) for holding the opposite end of the windmill wing (2).

7. A vehicle according to claims 2 - 6, **characterized in that** the non-tractive vehicle (5) is connected (6) hydraulically and electrically to the tractive vehicle (3).

### Patentansprüche

1. Verfahren für den Transport eines langen Windmühlenflügels (2), wobei der Windmühlenflügel mit seinem einen Ende an einem Zugfahrzeug (3) und mit seinem gegenüberliegenden Ende an einem Mitrollfahrzeug (5) befestigt ist und der Windmühlenflügel (2) am Zugfahrzeug (3) befestigt wird, indem ein Halterahmen (13) am einen Ende des Windmühlenflügels angebracht wird, wobei der Halterahmen mit einem hydraulischen System (4, 11) verbunden ist und dieses hydraulische System am Zugfahrzeug (3) angebracht ist, wobei das hydraulische System (4, 11) dazu eingerichtet ist, den Halterahmen mit dem Windmühlenflügel (2) anzuheben und abzusenken, **dadurch gekennzeichnet, dass** das hydraulische System weiterhin Kopplungseinrichtungen in Gestalt von Pfosten enthält und dass der Halterahmen (13) mit dem hydraulischen System **dadurch** gekoppelt wird, dass die Pfosten (12) in Halteteile (23, 24) am Halterahmen (13) eingefügt werden.
2. Fahrzeug für den Transport eines langen Windmühlenflügels (2), wobei das Fahrzeug aus einem Zugfahrzeug (3), an dem ein Ende des Windmühlenflügels befestigt ist, und einem Mitrollfahrzeug (5) besteht, an dem das andere Ende des Windmühlenflügels befestigt ist, wobei das Zugfahrzeug (3) mit einem hydraulischen System (4, 11) ausgestattet ist, das auf einer Konsole (21) angeordnet ist, die am Zugfahrzeug (3) vorgesehen ist, und dazu eingerichtet ist, den Windmühlenflügel anzuheben und abzusenken, **dadurch gekennzeichnet, dass** das hydraulische System (4, 11) weiterhin Kopplungseinrichtungen in Gestalt von Pfosten (12) zum Koppeln mit einem Halterahmen (13) enthält, der an dem einen Ende des Windmühlenflügels angebracht ist.
3. Fahrzeug nach Anspruch 2, **dadurch gekennzeichnet, dass** das hydraulische System (4, 11) drehbar um eine Achse senkrecht zu Straße angebracht ist, auf der das Fahrzeug bewegt wird, und auf einer Kugeldrehscheibe ruht.
4. Fahrzeug nach Anspruch 2 bis 3, **dadurch gekennzeichnet, dass** das Mitrollfahrzeug (5) mit einer Plattform versehen ist, auf der eine Trägeranordnung (26) zum Fixieren des Windmühlenflügels drehbar angebracht ist.
5. Fahrzeug nach Anspruch 4, **dadurch gekennzeichnet, dass** die Trägeranordnung (26) in der Höhe ein-

stellbar ist.

6. Fahrzeug nach Anspruch 4 bis 5, **dadurch gekennzeichnet, dass** die Trägeranordnung (26) als Halterung aufgebaut ist, die Halteprofile in Gestalt von Rahmen (27) zum Halten des gegenüberliegenden Endes des Windmühlenflügels (2) enthält.
7. Fahrzeug nach Anspruch 2 bis 6, **dadurch gekennzeichnet, dass** das Mitrollfahrzeug (5) mit dem Zugfahrzeug (3) hydraulisch und elektrisch verbunden ist.

#### Revendications

1. Procédé pour le transport d'une longue aile de moulin à vent (2), dans lequel l'aile de moulin à vent est fixée au niveau de l'une de ses extrémités à un véhicule tracteur (3) et est fixée au niveau de son extrémité opposée à un véhicule non tracteur (5), et dans lequel l'aile de moulin à vent (2) est fixée au véhicule tracteur (3) en montant un châssis de support (13) au niveau d'une extrémité de l'aile de moulin à vent, ledit châssis de support étant couplé à un système hydraulique (4, 11), lequel système hydraulique est agencé sur le véhicule tracteur (3), ledit système hydraulique (4, 11) étant adapté pour lever et faire descendre le châssis de support avec l'aile de moulin à vent (2), **caractérisé en ce que** le système hydraulique comprend en outre des moyens de couplage se présentant sous la forme de montants et **en ce que** le châssis de support (13) est couplé au système hydraulique en insérant les montants (12) dans les parties de support (23, 24) sur le châssis de support (13).
2. Véhicule pour le transport d'une longue aile de moulin à vent (2), ledit véhicule étant formé par un véhicule tracteur (3) auquel une extrémité de l'aile de moulin à vent est fixée, et un véhicule non tracteur (5) auquel l'autre extrémité de l'aile de moulin à vent est fixée, ledit véhicule tracteur (3) étant prévu avec un système hydraulique (4, 11) qui est agencé sur une console (21) prévue sur le véhicule tracteur (3) et est adapté pour lever et faire descendre l'aile de moulin à vent, **caractérisé en ce que** le système hydraulique (4, 11) comprend en outre des moyens de couplage se présentant sous la forme de montants (12) pour se coupler à un châssis de support (13) qui est monté sur une extrémité de l'aile de moulin à vent.
3. Véhicule selon la revendication 2, **caractérisé en ce que** le système hydraulique (4, 11) est monté de manière rotative sur un axe perpendiculaire à la route sur laquelle le véhicule est manoeuvré et disposé sur une plaque tournante à billes.

4. Véhicule selon les revendications 2 - 3, **caractérisé en ce que** le véhicule non tracteur (5) est prévu avec une plateforme sur laquelle un agencement de support (26) pour la fixation de l'aile de moulin à vent, est agencé de manière rotative.
5. Véhicule selon la revendication 4, **caractérisé en ce que** l'agencement de support (26) est ajustable en hauteur.
6. Véhicule selon les revendications 4 - 5, **caractérisé en ce que** l'agencement de support (26) est construit comme un support comprenant des profils de support se présentant sous la forme de châssis (27) pour supporter l'extrémité opposée de l'aile de moulin à vent (2).
7. Véhicule selon les revendications 2 à 6, **caractérisé en ce que** le véhicule non tracteur (5) est raccordé (6) hydrauliquement et électriquement au véhicule tracteur (3).

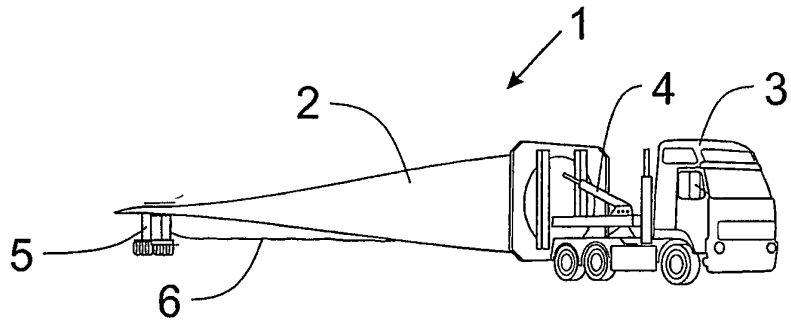

Fig. 1

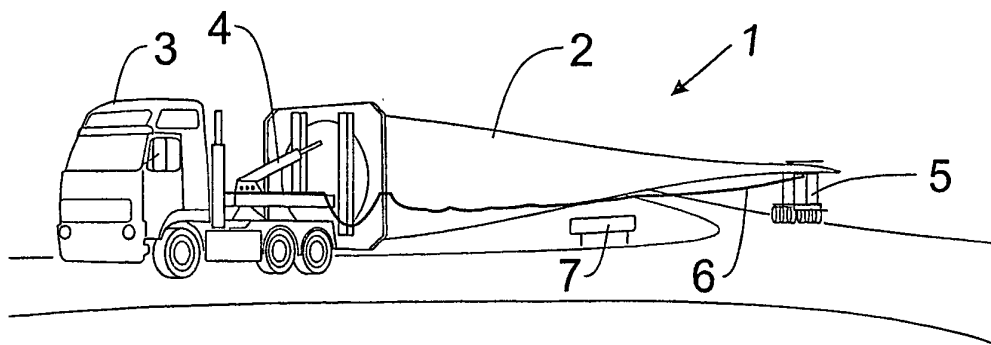
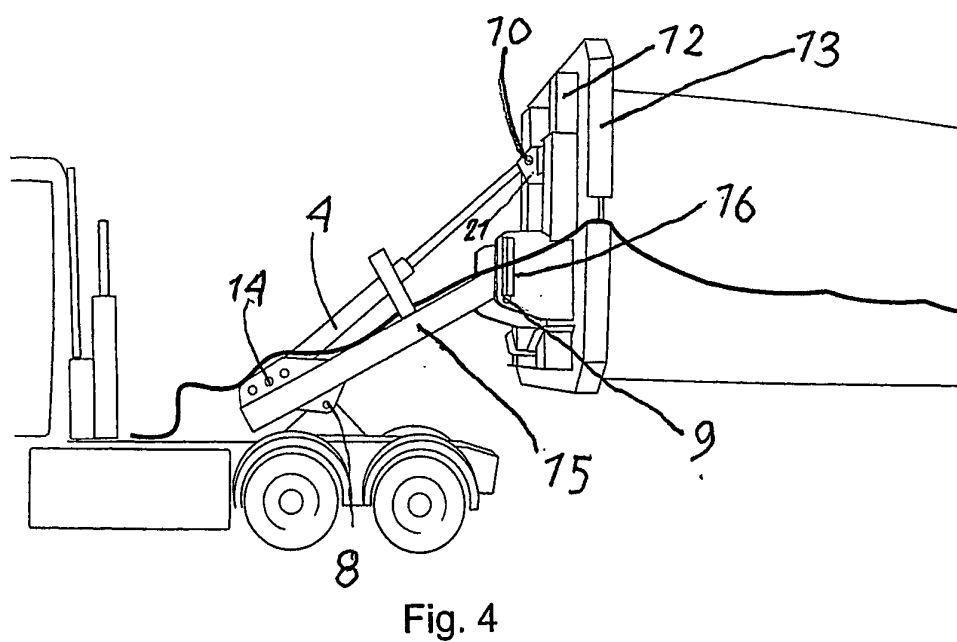
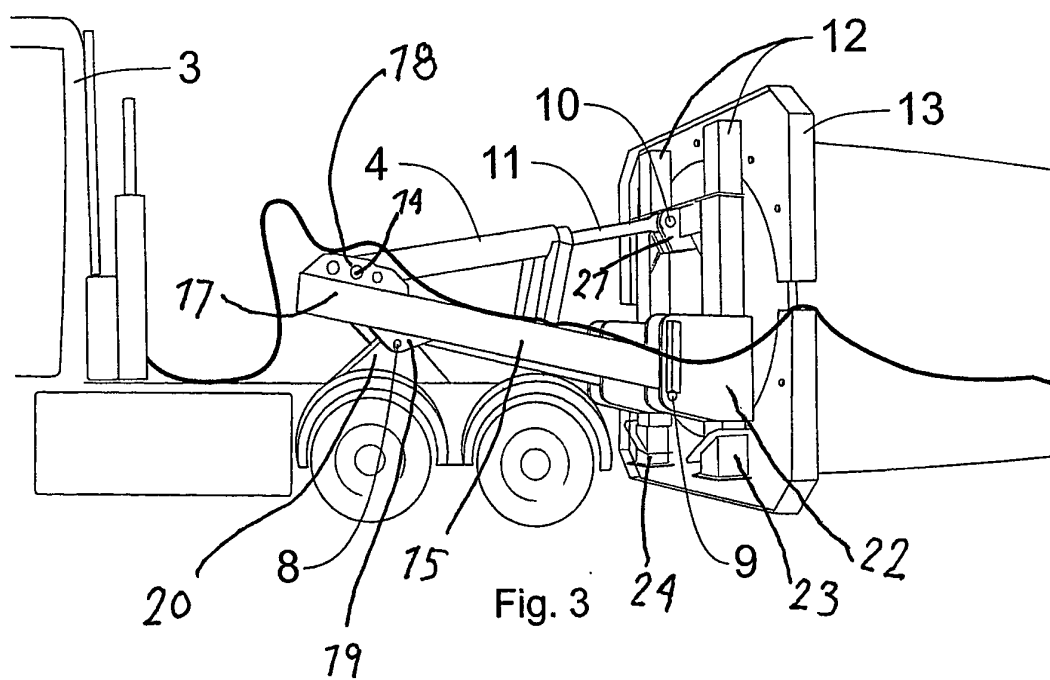

Fig. 2



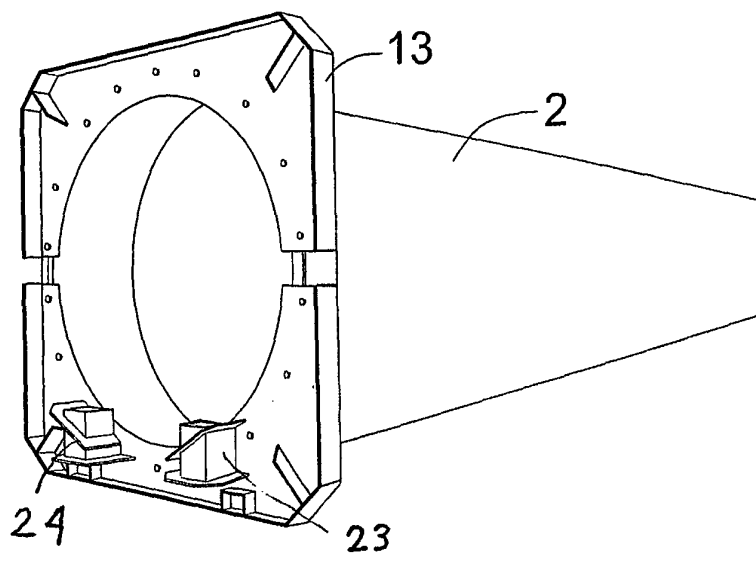

Fig. 5

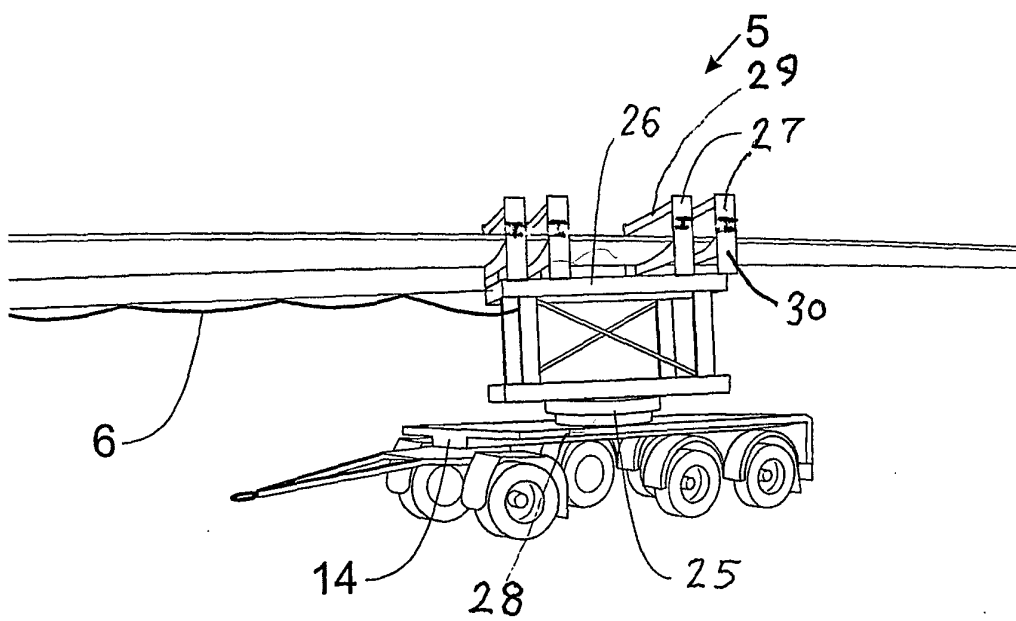

Fig. 6

## EP 1 773 621 B1

### REFERENCES CITED IN THE DESCRIPTION

*This list of references cited by the applicant is for the reader's convenience only. It does not form part of the European patent document. Even though great care has been taken in compiling the references, errors or omissions cannot be excluded and the EPO disclaims all liability in this regard.*

#### Patent documents cited in the description

- WO 03057528 A1 [0010]
- WO 2004041589 A1 [0015]